



रेल भर्ती बोर्ड / RAILWAY RECRUITMENT BOARDS

सी ई एन ०१/२०१९ - एन टी पी सी - CEN 01/2019 - NTPC



Participant ID	
Participant Name	
Test Center Name	Shri Siddhi Vinayak Institute Of Technology
Test Date	31/01/2021
Test Time	3:00 PM - 4:30 PM
Subject	NTPC

*** Note**

Correct Answer will carry 1 mark per Question.
Incorrect Answer will carry 1/3 Negative mark.

- Options shown in green color with a tick icon are correct.
- Chosen option on the right of the question indicates the option selected by the candidate.

Section : NTPC

Q.1 The Constitution of India provides for a _____ structure of governance in the form of Parliamentary Democracy both at the Centre and the State.

- Ans**
- ☒ 1. singular system
 - ☒ 2. dual system
 - ☒ 3. quasi-federal
 - ☒ 4. federal

Question ID : 9489115829

Option 1 ID : 94891123316

Option 2 ID : 94891123315

Option 3 ID : 94891123313

Option 4 ID : 94891123314

Status : Answered

Chosen Option : 4

Test Prime

**ALL EXAMS,
ONE SUBSCRIPTION**



70,000+
Mock Tests



**Personalised
Report Card**



**Unlimited
Re-Attempt**



600+
Exam Covered



**Previous Year
Papers**



**500%
Refund**



ATTEMPT FREE MOCK NOW

Q.2 Which of the following is a programme that translates each instruction of high-level language and executes it before passing on to the next instruction?

- Ans
- ☐ 1. Assembler
 - ☐ 2. Multiprocessing
 - ☒ 3. Interpreter
 - ☐ 4. Data Processing

Question ID : 9489115838
Option 1 ID : 94891123350
Option 2 ID : 94891123351
Option 3 ID : 94891123349
Option 4 ID : 94891123352
Status : Answered
Chosen Option : 1

Q.3 Which of the following cities hosted the 4-day India International Cherry Blossom festival in 2019?

- Ans
- ☐ 1. Guwahati
 - ☐ 2. Imphal
 - ☒ 3. Shillong
 - ☐ 4. Agartala

Question ID : 9489115822
Option 1 ID : 94891123288
Option 2 ID : 94891123286
Option 3 ID : 94891123285
Option 4 ID : 94891123287
Status : Answered
Chosen Option : 3

Q.4 Which of the following are stored in the form of starch which serves as an internal energy reserve to be used as and when required by the plant?

- Ans
- ☐ 1. sunlight
 - ☐ 2. oxygen
 - ☐ 3. water
 - ☒ 4. carbohydrates

Question ID : 9489115815
Option 1 ID : 94891123260
Option 2 ID : 94891123258
Option 3 ID : 94891123257
Option 4 ID : 94891123259
Status : Answered
Chosen Option : 2

Q.5 An aquarium is in the form of a cuboid whose external measures are $80 \text{ cm} \times 30 \text{ cm} \times 40 \text{ cm}$. The base, side faces and back face are to be covered with a coloured paper. Find the area of the paper needed?

- Ans**
- ☒ 1. 6000 cm^2
 - ☒ 2. 8000 cm^2
 - ☒ 3. 8050 cm^2
 - ☒ 4. 8080 cm^2

Question ID : 9489115364

Option 1 ID : 94891121453

Option 2 ID : 94891121455

Option 3 ID : 94891121454

Option 4 ID : 94891121456

Status : Answered

Chosen Option : 4

Q.6 From a point Y on a level ground, the angle of elevation of the top of a lamp post is 45° . If the distance of point Y from the foot of the lamp post is 80 m, the height of the lamp post will be:

- Ans**
- ☒ 1. 70 m
 - ☒ 2. 80 m
 - ☒ 3. 82 m
 - ☒ 4. 78 m

Question ID : 9489115373

Option 1 ID : 94891121491

Option 2 ID : 94891121489

Option 3 ID : 94891121492

Option 4 ID : 94891121490

Status : Answered

Chosen Option : 2

Q.7 How much does one need to add to $\frac{1}{2}$ to get 2?

- Ans**
- ☒ 1. $\frac{3}{2}$
 - ☒ 2. $\frac{1}{-1}$
 - ☒ 3. $\frac{1}{2}$
 - ☒ 4. $\frac{5}{3}$

Question ID : 9489115347

Option 1 ID : 94891121386

Option 2 ID : 94891121388

Option 3 ID : 94891121385

Option 4 ID : 94891121387

Status : Answered

Chosen Option : 1

Q.8 In the following diagram, if the triangle represents the people who drink green tea, the circle represents the people who drink coffee and the rectangle represents the people who drink milk, then how many people like both green tea and coffee?

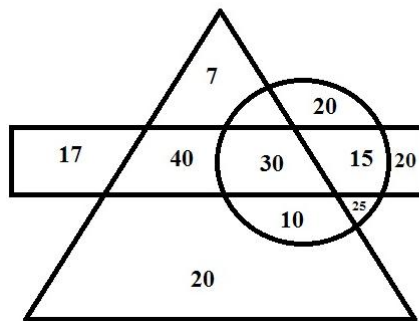

- Ans**
- ☒ 1. 47
 - ☒ 2. 80
 - ☒ 3. 40
 - ☒ 4. 37

Question ID : 9489115697

Option 1 ID : 94891122787

Option 2 ID : 94891122785

Option 3 ID : 94891122788

Option 4 ID : 94891122786

Status : Answered

Chosen Option : 3

Q.9 Ameesha can complete a task by herself in 14 days, while it takes Bhavya 35 days to complete it alone. Together with Chitra, they can complete the task in 6 days. How many days will Chitra need to complete the task alone?

- Ans**
- ☒ 1. 43
 - ☒ 2. 28
 - ☒ 3. 14
 - ☒ 4. 15

Question ID : 9489115361

Option 1 ID : 94891121441

Option 2 ID : 94891121442

Option 3 ID : 94891121444

Option 4 ID : 94891121443

Status : Answered

Chosen Option : 4

Q.10 If $A : B = 1 : 3$, $B : C = 5 : 4$ and $C : D = 2 : 3$, then the value of $A : B : C : D$ will be:

- Ans
- ☒ 1. $4 : 9 : 12 : 16$
 - ☒ 2. $3 : 8 : 9 : 12$
 - ☒ 3. $4 : 12 : 18 : 20$
 - ☒ 4. $5 : 15 : 12 : 18$

Question ID : 9489115357

Option 1 ID : 94891121428

Option 2 ID : 94891121427

Option 3 ID : 94891121425

Option 4 ID : 94891121426

Status : Answered

Chosen Option : 4

Q.11 Name the Metro Rail Corporation which has become the first ever project in the country to receive power generated from a waste-to-energy plant.

- Ans
- ☒ 1. Chennai metro
 - ☒ 2. Mumbai metro
 - ☒ 3. Delhi metro
 - ☒ 4. Bangalore metro

Question ID : 9489115842

Option 1 ID : 94891123366

Option 2 ID : 94891123367

Option 3 ID : 94891123365

Option 4 ID : 94891123368

Status : Answered

Chosen Option : 3

Q.12 Rajiv Mehrishi has been elected as external auditor of which international organisation from 2020 to 2023?

- Ans
- ☒ 1. WHO
 - ☒ 2. IMF
 - ☒ 3. WTO
 - ☒ 4. UNICEF

Question ID : 9489115834

Option 1 ID : 94891123335

Option 2 ID : 94891123336

Option 3 ID : 94891123334

Option 4 ID : 94891123333

Status : Answered

Chosen Option : 3

Q.13 In a certain code, ZEBRA is written as ZQADY. How will HINTS be written as in that code?

- Ans ☒ 1. HUMFQ
☒ 2. HVMQF
☒ 3. HTMFQ
☒ 4. HSFQM

Question ID : 9489115677
Option 1 ID : 94891122706
Option 2 ID : 94891122705
Option 3 ID : 94891122707
Option 4 ID : 94891122708
Status : Not Answered
Chosen Option : --

Q.14 Study the given pattern carefully and select the number that can replace the question mark (?) in it.

48	64	80
24	?	40
12	16	20

- Ans ☒ 1. 24
☒ 2. 32
☒ 3. 28
☒ 4. 34

Question ID : 9489115700
Option 1 ID : 94891122800
Option 2 ID : 94891122797
Option 3 ID : 94891122798
Option 4 ID : 94891122799
Status : Answered
Chosen Option : 2

Q.15 If $\tan \theta + \cot \theta = 6$, then find the value of $\tan^2 \theta + \cot^2 \theta$

- Ans ☒ 1. 54
☒ 2. 34
☒ 3. 44
☒ 4. 24

Question ID : 9489115368
Option 1 ID : 94891121472
Option 2 ID : 94891121470
Option 3 ID : 94891121471
Option 4 ID : 94891121469
Status : Answered
Chosen Option : 2

Q.16 30 ml paint is required to paint a circular plate of 20 cm radius. How much paint is required to paint a similar plate of radius 80 cm?

- Ans
- ☒ 1. 360 ml
 - ☒ 2. 480 ml
 - ☒ 3. 300 ml
 - ☒ 4. 450 ml

Question ID : 9489115366
 Option 1 ID : 94891121461
 Option 2 ID : 94891121463
 Option 3 ID : 94891121462
 Option 4 ID : 94891121464
 Status : Not Answered
 Chosen Option : --

Q.17 In which year did Indian National Congress observe 26 January as Independence Day for the first time?

- Ans
- ☒ 1. 1930
 - ☒ 2. 1947
 - ☒ 3. 1915
 - ☒ 4. 1929

Question ID : 9489115817
 Option 1 ID : 94891123265
 Option 2 ID : 94891123267
 Option 3 ID : 94891123268
 Option 4 ID : 94891123266
 Status : Answered
 Chosen Option : 1

Q.18 The HCF of two even numbers should be at least _____.

- Ans
- ☒ 1. 0
 - ☒ 2. 1
 - ☒ 3. 4
 - ☒ 4. 2

Question ID : 9489115346
 Option 1 ID : 94891121381
 Option 2 ID : 94891121382
 Option 3 ID : 94891121384
 Option 4 ID : 94891121383
 Status : Answered
 Chosen Option : 4

Q.19 Which of the following statements about plant tissues is INCORRECT?

- Ans
- ☒ 1. Xylem and phloem are complex tissues.
 - ☒ 2. Phloem transports food from leaves to other parts of the plant.
 - ☒ 3. Xylem transports water and minerals.
 - ☒ 4. Materials can move in both directions in xylem.

Question ID : 9489115814

Option 1 ID : 94891123254

Option 2 ID : 94891123255

Option 3 ID : 94891123253

Option 4 ID : 94891123256

Status : Answered

Chosen Option : 4

Q.20 Which are the two main organs in the human body where the magnetic field produced is significant?

- Ans
- ☒ 1. Stomach and intestines
 - ☒ 2. Lungs and liver
 - ☒ 3. Liver and gallbladder
 - ☒ 4. Heart and brain

Question ID : 9489115816

Option 1 ID : 94891123263

Option 2 ID : 94891123264

Option 3 ID : 94891123261

Option 4 ID : 94891123262

Status : Answered

Chosen Option : 4

Q.21 In which of the following states is the Gambhira - a popular dance, performed using various wooden masks?

- Ans
- ☒ 1. West Bengal
 - ☒ 2. Rajasthan
 - ☒ 3. Telangana
 - ☒ 4. Gujarat

Question ID : 9489115809

Option 1 ID : 94891123236

Option 2 ID : 94891123235

Option 3 ID : 94891123233

Option 4 ID : 94891123234

Status : Answered

Chosen Option : 1

Q.22 Which are the top performing states in NITI Aayog's SDG India index released in 2019?

- Ans ☒ 1. Kerala, Himachal Pradesh
☐ 2. Assam, Bihar, Uttar Pradesh
☐ 3. Haryana, Goa, Gujarat
☐ 4. Maharashtra, Punjab

Question ID : 9489115843

Option 1 ID : 94891123369

Option 2 ID : 94891123372

Option 3 ID : 94891123370

Option 4 ID : 94891123371

Status : Answered

Chosen Option : 1

Q.23 John is twice as old as Jean. After 3 years, the sum of their ages will be 66 years. What are the present ages of Jean and John, respectively?

- Ans ☐ 1. 40 and 20 years
☐ 2. 42 and 84 years
☒ 3. 20 and 40 years
☐ 4. 24 and 48 years

Question ID : 9489115685

Option 1 ID : 94891122737

Option 2 ID : 94891122740

Option 3 ID : 94891122738

Option 4 ID : 94891122739

Status : Answered

Chosen Option : 3

Q.24 Which of the following is India's highest ranked City in Safest City category in the Mercer's 2019 Quality of Living Index?

- Ans ☒ 1. Chennai
☐ 2. Delhi
☐ 3. Mumbai
☐ 4. Bangalore

Question ID : 9489115824

Option 1 ID : 94891123296

Option 2 ID : 94891123293

Option 3 ID : 94891123294

Option 4 ID : 94891123295

Status : Answered

Chosen Option : 4

Q.25 Read the given statements and conclusions carefully. Assuming that the information given in the statements is true, even if it appears to be at variance with commonly known facts, decide which of the given conclusions logically follow(s) from the statements.

Statements:

- (a) All leaders are corrupt.
(b) Some women are leaders.

Conclusions:

- I. Some women are corrupt.
II. All those corrupt are women.

- Ans**
- ☒ 1. Both conclusion I and II follow.
 - ☒ 2. Neither conclusion I nor conclusion II follows.
 - ☒ 3. Only conclusion II follows.
 - ☒ 4. Only conclusion I follows.

Question ID : 9489115698

Option 1 ID : 94891122791

Option 2 ID : 94891122792

Option 3 ID : 94891122790

Option 4 ID : 94891122789

Status : Answered

Chosen Option : 4

Q.26 The difference between 48% and 38% of a number is 354. What is 58% of that number?

- Ans**
- ☒ 1. 2034.6
 - ☒ 2. 1987.56
 - ☒ 3. 1893.78
 - ☒ 4. 2053.2

Question ID : 9489115348

Option 1 ID : 94891121392

Option 2 ID : 94891121390

Option 3 ID : 94891121389

Option 4 ID : 94891121391

Status : Answered

Chosen Option : 4

Q.27 How many heart chambers do mammals have?

- Ans ☒ 1. four
☐ 2. three
☐ 3. single
☐ 4. two

Question ID : 9489115812
Option 1 ID : 94891123246
Option 2 ID : 94891123245
Option 3 ID : 94891123248
Option 4 ID : 94891123247
Status : Answered
Chosen Option : 1

Q.28 Which of the following is related to the Arvind Subramanian Committee?

- Ans ☐ 1. Rural credits
☐ 2. Taxation of E-commerce
☒ 3. GST
☐ 4. Mining policy

Question ID : 9489115839
Option 1 ID : 94891123353
Option 2 ID : 94891123354
Option 3 ID : 94891123355
Option 4 ID : 94891123356
Status : Answered
Chosen Option : 2

Q.29 Select the word that does NOT belong to the following group.

Chilli, Cumin, Capsicum, Cardamom

- Ans ☐ 1. Chilli
☐ 2. Cardamom
☐ 3. Cumin
☒ 4. Capsicum

Question ID : 9489115693
Option 1 ID : 94891122769
Option 2 ID : 94891122772
Option 3 ID : 94891122770
Option 4 ID : 94891122771
Status : Answered
Chosen Option : 2

Q.30 Which of the following Articles of the constitution refers to the Union Budget as the Annual Financial Statement?

- Ans**
- ☒ 1. Article 102
 - ☒ 2. Article 113
 - ☒ 3. Article 101
 - ☒ 4. Article 112

Question ID : 9489115840

Option 1 ID : 94891123359

Option 2 ID : 94891123357

Option 3 ID : 94891123360

Option 4 ID : 94891123358

Status : Answered

Chosen Option : 4

Q.31 Which of the following state government's Medical and Health Departments has been awarded by WHO (in the year 2019) for its achievements in the field of tobacco control?

- Ans**
- ☒ 1. Rajasthan
 - ☒ 2. Punjab
 - ☒ 3. Uttar Pradesh
 - ☒ 4. Bihar

Question ID : 9489115833

Option 1 ID : 94891123329

Option 2 ID : 94891123331

Option 3 ID : 94891123330

Option 4 ID : 94891123332

Status : Answered

Chosen Option : 1

Q.32 The release of which hormone causes simultaneous increase in heartbeat and breathing rate?

- Ans**
- ☒ 1. Serotonin
 - ☒ 2. Adrenaline
 - ☒ 3. Estrogen
 - ☒ 4. Thyroxin

Question ID : 9489115811

Option 1 ID : 94891123244

Option 2 ID : 94891123243

Option 3 ID : 94891123242

Option 4 ID : 94891123241

Status : Answered

Chosen Option : 2

Q.33 Who became the third Cricketer to receive the Rajiv Gandhi Khel Ratna award?

- Ans
- ☐ 1. M S Dhoni
 - ☐ 2. Sachin Tendulkar
 - ☐ 3. Rohit Sharma
 - ☒ 4. Virat Kohli

Question ID : 9489115804

Option 1 ID : 94891123215

Option 2 ID : 94891123214

Option 3 ID : 94891123216

Option 4 ID : 94891123213

Status : Answered

Chosen Option : 4

Q.34 HCF and LCM of two numbers are 5 and 210 respectively. If the numbers are between 25 and 40, the sum of the numbers will be:

- Ans
- ☐ 1. 55
 - ☐ 2. 60
 - ☒ 3. 65
 - ☐ 4. 50

Question ID : 9489115345

Option 1 ID : 94891121378

Option 2 ID : 94891121379

Option 3 ID : 94891121380

Option 4 ID : 94891121377

Status : Answered

Chosen Option : 3

Q.35 Which of the following is the system designed to prevent unauthorised access to or from a private network?

- Ans
- ☐ 1. Repeater
 - ☐ 2. Packet filter
 - ☐ 3. Bridge
 - ☒ 4. Firewall

Question ID : 9489115837

Option 1 ID : 94891123346

Option 2 ID : 94891123347

Option 3 ID : 94891123345

Option 4 ID : 94891123348

Status : Answered

Chosen Option : 4

Q.36 Who proclaimed the formation of a provisional government of the Azad Hind on October 21, 1943?

- Ans**
- ☒ 1. Vir Savarkar
 - ☒ 2. Sardar Vallabhbhai Patel
 - ☒ 3. CR Das
 - ☒ 4. Subhash Chandra Bose

Question ID : 9489115818

Option 1 ID : 94891123271

Option 2 ID : 94891123272

Option 3 ID : 94891123270

Option 4 ID : 94891123269

Status : Answered

Chosen Option : 4

Q.37 Find the relation between x and y such that the point (x, y) is equidistant from (6, 2) and (4, 6).

- Ans**
- ☒ 1. $x + 2y = 3$
 - ☒ 2. $2x - y = 3$
 - ☒ 3. $2x + y = -3$
 - ☒ 4. $x - 2y = -3$

Question ID : 9489115369

Option 1 ID : 94891121475

Option 2 ID : 94891121473

Option 3 ID : 94891121476

Option 4 ID : 94891121474

Status : Answered

Chosen Option : 3

Q.38 A started a journey at 1:00 p.m. at a speed of 40 km/h. B started from the same spot and in the same direction at 1:40 p.m. at a speed of 50 km/h. How many minutes will B take to catch up with A?

- Ans**
- ☒ 1. 150 min
 - ☒ 2. 120 min
 - ☒ 3. 140 min
 - ☒ 4. 160 min

Question ID : 9489115362

Option 1 ID : 94891121447

Option 2 ID : 94891121445

Option 3 ID : 94891121446

Option 4 ID : 94891121448

Status : Answered

Chosen Option : 4

Q.39 Waheeda bought an air cooler for ₹3,300 including a tax of 10%. Find the price of the air cooler before tax was added.

- Ans
- ☒ 1. ₹2,900
 - ☒ 2. ₹2,800
 - ☒ 3. ₹3,000
 - ☒ 4. ₹3,300

Question ID : 9489115354

Option 1 ID : 94891121415

Option 2 ID : 94891121413

Option 3 ID : 94891121414

Option 4 ID : 94891121416

Status : Answered

Chosen Option : 3

Q.40 Which of the following organisations incorporated New Space India Limited (NSIL) on March 6, 2019, for commercially utilising research development activities in the area of space?

- Ans
- ☒ 1. DRDO
 - ☒ 2. CSIR
 - ☒ 3. NASA
 - ☒ 4. ISRO

Question ID : 9489115830

Option 1 ID : 94891123318

Option 2 ID : 94891123317

Option 3 ID : 94891123320

Option 4 ID : 94891123319

Status : Answered

Chosen Option : 4

Q.41 Which of the following gases makes up 78% of our atmosphere and also a part of many molecules essential to life?

- Ans
- ☒ 1. Carbon
 - ☒ 2. Helium
 - ☒ 3. Nitrogen
 - ☒ 4. Oxygen

Question ID : 9489115813

Option 1 ID : 94891123250

Option 2 ID : 94891123249

Option 3 ID : 94891123252

Option 4 ID : 94891123251

Status : Answered

Chosen Option : 3

Q.42 An amount of money is to be divided between A, B and C in the ratio of 5 : 2 : 8. If the difference between the shares of A and C is ₹7,740, then what will be the total amount?

- Ans**
- ☒ 1. ₹28,976
 - ☒ 2. ₹38,700
 - ☒ 3. ₹35,875
 - ☒ 4. ₹30,983

Question ID : 9489115358

Option 1 ID : 94891121429

Option 2 ID : 94891121431

Option 3 ID : 94891121432

Option 4 ID : 94891121430

Status : Answered

Chosen Option : 2

Q.43 If a vessel gets filled by 15 glasses of milk where capacity of each glass is 1.5 L, how many glasses are required to fill the same vessel if the capacity of each glass is 0.5 L?

- Ans**
- ☒ 1. 40
 - ☒ 2. 45
 - ☒ 3. 50
 - ☒ 4. 55

Question ID : 9489115352

Option 1 ID : 94891121405

Option 2 ID : 94891121406

Option 3 ID : 94891121407

Option 4 ID : 94891121408

Status : Answered

Chosen Option : 2

Q.44 What percentage of profit on cost price equals 20% of profit on selling price?

- Ans**
- ☒ 1. 28%
 - ☒ 2. 30%
 - ☒ 3. 25%
 - ☒ 4. 22%

Question ID : 9489115359

Option 1 ID : 94891121435

Option 2 ID : 94891121436

Option 3 ID : 94891121434

Option 4 ID : 94891121433

Status : Answered

Chosen Option : 3

Q.45 Which of the following was introduced as the 101st Amendment of the Constitution of India on July 1, 2017?

Ans

- ✓ 1. Goods and Service Tax
- ✗ 2. Land boundary agreement between India and Bangladesh
- ✗ 3. Replacing Orissa with Odisha
- ✗ 4. Constitutional status of cooperatives

Question ID : 9489115827

Option 1 ID : 94891123308

Option 2 ID : 94891123305

Option 3 ID : 94891123306

Option 4 ID : 94891123307

Status : Answered

Chosen Option : 1



Q.46 Which cube given in the options CANNOT be made using the following sheet?

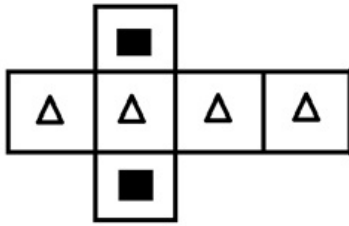

Ans

✗ 1.



✓ 2.



✗ 3.



✗ 4.



Question ID : 9489115699
Option 1 ID : 94891122796
Option 2 ID : 94891122794
Option 3 ID : 94891122793
Option 4 ID : 94891122795

Status : Answered

Chosen Option : 2

Q.47 The Union Cabinet has approved the continuation of the GSLV phase-4 programmes consisting of five GSLV flights during the period ____.

- Ans
- ☐ 1. 2024-2028
 - ☐ 2. 2020 -2023
 - ☐ 3. 2022-2025
 - ☒ 4. 2021-2024

Question ID : 9489115831

Option 1 ID : 94891123323

Option 2 ID : 94891123321

Option 3 ID : 94891123324

Option 4 ID : 94891123322

Status : Answered

Chosen Option : 4

Q.48 What is the value of the following expression?

$$\frac{\cos 3x + \cos x}{\sin 3x - \sin x}$$

- Ans
- ☐ 1. $\tan x$
 - ☐ 2. $\sin x$
 - ☐ 3. $\cos x$
 - ☒ 4. $\cot x$

Question ID : 9489115370

Option 1 ID : 94891121480

Option 2 ID : 94891121478

Option 3 ID : 94891121477

Option 4 ID : 94891121479

Status : Answered

Chosen Option : 4

Q.49 Which of the following is a folk dance of Maharashtra?

- Ans
- ☐ 1. Bihu
 - ☒ 2. Lavani
 - ☐ 3. Baul
 - ☐ 4. Mando

Question ID : 9489115808

Option 1 ID : 94891123229

Option 2 ID : 94891123230

Option 3 ID : 94891123232

Option 4 ID : 94891123231

Status : Answered

Chosen Option : 2

Q.50 In which of the following places did the English open their 'factory' in 1611 on east coast of India?

- Ans ☒ 1. Masulipatnam
☐ 2. Madras
☐ 3. Tuticorin
☐ 4. Yanam

Question ID : 9489115819

Option 1 ID : 94891123275

Option 2 ID : 94891123276

Option 3 ID : 94891123274

Option 4 ID : 94891123273

Status : Answered

Chosen Option : 1

Q.51 Name the Indian Executive who has been chosen for the Prestigious USIBC Global Leadership Award 2020.

- Ans ☐ 1. Indra Nooyi
☐ 2. Lakshmi Mittal
☒ 3. N Chandrasekaran
☐ 4. Ajaypal Singh Banga

Question ID : 9489115806

Option 1 ID : 94891123222

Option 2 ID : 94891123224

Option 3 ID : 94891123221

Option 4 ID : 94891123223

Status : Answered

Chosen Option : 1

Q.52 Which of the following articles provided that an Inter-State Council can be formed by a Presidential Order?

- Ans ☐ 1. Article 261
☒ 2. Article 263
☐ 3. Article 262
☐ 4. Article 264

Question ID : 9489115828

Option 1 ID : 94891123311

Option 2 ID : 94891123312

Option 3 ID : 94891123310

Option 4 ID : 94891123309

Status : Answered

Chosen Option : 2

Q.53 A sum of ₹20,000 is borrowed by Heena for 2 years at an interest of 8% compounded annually. Find the compound interest.

- Ans
- ☒ 1. ₹3,428
 - ☒ 2. ₹3,328
 - ☒ 3. ₹3,028
 - ☒ 4. ₹3,628

Question ID : 9489115355

Option 1 ID : 94891121419

Option 2 ID : 94891121420

Option 3 ID : 94891121417

Option 4 ID : 94891121418

Status : Answered

Chosen Option : 2

Q.54 How many nuclear power plants has the United States agreed to set-up in India to strengthen bilateral security and civil nuclear cooperation between the two nations?

- Ans
- ☒ 1. Four
 - ☒ 2. Six
 - ☒ 3. Eight
 - ☒ 4. Five

Question ID : 9489115832

Option 1 ID : 94891123325

Option 2 ID : 94891123328

Option 3 ID : 94891123326

Option 4 ID : 94891123327

Status : Answered

Chosen Option : 1

Q.55 If the length and the perimeter of a rectangle are in the ratio of 3 : 20, then its length and breadth will be in the ratio of:

- Ans
- ☒ 1. 3 : 7
 - ☒ 2. 3 : 6
 - ☒ 3. 3 : 5
 - ☒ 4. 3 : 4

Question ID : 9489115371

Option 1 ID : 94891121484

Option 2 ID : 94891121483

Option 3 ID : 94891121482

Option 4 ID : 94891121481

Status : Answered

Chosen Option : 1

Q.56 The LCM of two positive integers is thrice the larger number. The difference of the smaller number and the HCF of the two numbers is 6. The smaller number is:

- Ans** ☒ 1. 9
☒ 2. 5
☒ 3. 11
☒ 4. 7

Question ID : 9489115353

Option 1 ID : 94891121409

Option 2 ID : 94891121411

Option 3 ID : 94891121412

Option 4 ID : 94891121410

Status : Not Answered

Chosen Option : --

Q.57 Who among the following became the fastest batsman to score 5000 runs in the IPL?

- Ans** ☒ 1. David Warner
☒ 2. Suresh Raina
☒ 3. Rohit Sharma
☒ 4. MS Dhoni

Question ID : 9489115805

Option 1 ID : 94891123220

Option 2 ID : 94891123217

Option 3 ID : 94891123218

Option 4 ID : 94891123219

Status : Answered

Chosen Option : 1

Q.58 If 'X + Y' means 'X is the brother of Y', 'X × Y' means 'X is the father of Y' and 'X / Y' means 'X is the mother of Y', then which of the following would mean 'R is the son of S'?

- Ans** ☒ 1. $S \times T \times R$
☒ 2. $S / R / T$
☒ 3. $S \times R + T$
☒ 4. $S + R \times T$

Question ID : 9489115680

Option 1 ID : 94891122717

Option 2 ID : 94891122719

Option 3 ID : 94891122720

Option 4 ID : 94891122718

Status : Answered

Chosen Option : 3

Q.59 A wire in the form of a circle of radius 56 m is cut and again bent in the form of a square. What is the measure of the diagonal of the square?

- Ans
- ☒ 1. $85\sqrt{3}$ m
 - ☒ 2. $90\sqrt{2}$ m
 - ☒ 3. $80\sqrt{2}$ m
 - ☒ 4. $88\sqrt{2}$ m

Question ID : 9489115372

Option 1 ID : 94891121487

Option 2 ID : 94891121488

Option 3 ID : 94891121486

Option 4 ID : 94891121485

Status : Answered

Chosen Option : 4

Q.60 A godown is in the form of a cuboid of measures $60\text{ m} \times 40\text{ m} \times 30\text{ m}$. How many cuboidal boxes can be stored in it if the volume of one box is 0.8 m^3 ?

- Ans
- ☒ 1. 90,000
 - ☒ 2. 85,000
 - ☒ 3. 78,800
 - ☒ 4. 80,000

Question ID : 9489115365

Option 1 ID : 94891121460

Option 2 ID : 94891121459

Option 3 ID : 94891121458

Option 4 ID : 94891121457

Status : Answered

Chosen Option : 1

Q.61 Out of four brothers, M, N, O and P, M and N play cricket and football, N and O play cricket and hockey, O and P play hockey and basketball, P and M play football and basketball. Who plays football, basketball and hockey?

- Ans
- ☒ 1. P
 - ☒ 2. O
 - ☒ 3. N
 - ☒ 4. M

Question ID : 9489115703

Option 1 ID : 94891122810

Option 2 ID : 94891122812

Option 3 ID : 94891122809

Option 4 ID : 94891122811

Status : Answered

Chosen Option : 1

Q.62 Pointing to a boy in a photograph, Anil said, "His father's sister is the only daughter of my father's father." How is the boy's father related to Anil?

- Ans**
- ✓ 1. Father's Brother
 - ✗ 2. Father's Brother's Son
 - ✗ 3. Father's Father
 - ✗ 4. Brother

Question ID : 9489115678

Option 1 ID : 94891122710

Option 2 ID : 94891122712

Option 3 ID : 94891122711

Option 4 ID : 94891122709

Status : Answered

Chosen Option : 4

Q.63 In the following question below are given some statements followed by some conclusions based on those statements. Taking the given statements to be true even if they seem to be at variance from commonly known facts. Read all the conclusions and then decide which of the given conclusion logically follows the given statements.

Statements:

I. All D are E.

II. Some E are F.

Conclusions:

I. All D are F.

II. Some F are D.

III. Some F are E.

- Ans**
- ✗ 1. All conclusion follows
 - ✗ 2. Only conclusion I follows
 - ✓ 3. Only conclusion III follows
 - ✗ 4. Both conclusion II and III follows

Question ID : 9489115681

Option 1 ID : 94891122722

Option 2 ID : 94891122721

Option 3 ID : 94891122723

Option 4 ID : 94891122724

Status : Answered

Chosen Option : 3

Q.64 The sum of two numbers is 66 and their HCF and LCM are 3 and 315 respectively. The sum of the reciprocals of the numbers will be:

Ans

☐ 1. $\frac{56}{315}$

☒ 2. $\frac{22}{315}$

☐ 3. $\frac{66}{315}$

☐ 4. $\frac{3}{315}$

Question ID : 9489115351

Option 1 ID : 94891121404

Option 2 ID : 94891121403

Option 3 ID : 94891121401

Option 4 ID : 94891121402

Status : Answered

Chosen Option : 3

Q.65 When did the British army under Eyre Coote defeat Haider Ali at Porto Novo and save Madras?

Ans

☐ 1. July 1771

☒ 2. July 1781

☐ 3. July 1780

☐ 4. July 1761

Question ID : 9489115821

Option 1 ID : 94891123283

Option 2 ID : 94891123284

Option 3 ID : 94891123281

Option 4 ID : 94891123282

Status : Answered

Chosen Option : 2

Q.66 Which Abhiyan was launched in 2014 on the birth anniversary of the Father of the Nation?

Ans

☐ 1. Pulse Polio

☐ 2. Saansad Adarsh Gram Yojana

☒ 3. Swachh Bharat

☐ 4. Rashtriya Arogya Nidhi

Question ID : 9489115826

Option 1 ID : 94891123301

Option 2 ID : 94891123304

Option 3 ID : 94891123303

Option 4 ID : 94891123302

Status : Answered

Chosen Option : 3

Q.67 Which of the following Acts ended the trade monopoly of the Company in India and opened it to all British subjects except tea?

- Ans
- ☐ 1. Regulating Act, 1773
 - ☒ 2. Charter Act of 1813
 - ☐ 3. Indian Council Act, 1861
 - ☐ 4. Government of India Act, 1935

Question ID : 9489115820
Option 1 ID : 94891123280
Option 2 ID : 94891123278
Option 3 ID : 94891123277
Option 4 ID : 94891123279
Status : Answered
Chosen Option : 2

Q.68 How many numbers between 1 and 100 are exactly divisible by 6 and 8 both?

- Ans
- ☐ 1. 5
 - ☐ 2. 6
 - ☐ 3. 7
 - ☒ 4. 4

Question ID : 9489115349
Option 1 ID : 94891121394
Option 2 ID : 94891121395
Option 3 ID : 94891121396
Option 4 ID : 94891121393
Status : Answered
Chosen Option : 4

Q.69 Which of the following ministries launched a theme song 'Hawa Aane De' on air pollution in 2019?

- Ans
- ☐ 1. Science and Technology
 - ☐ 2. Agriculture
 - ☒ 3. Environment, forest and climate change
 - ☐ 4. Human Resource

Question ID : 9489115841
Option 1 ID : 94891123361
Option 2 ID : 94891123363
Option 3 ID : 94891123364
Option 4 ID : 94891123362
Status : Answered
Chosen Option : 3

Q.70 _____ is a generic term, which refers to all the legal and regulatory aspects of Internet and the World Wide Web.

- Ans
- ☐ 1. Hackers
 - ☐ 2. Cookies
 - ☐ 3. Tool
 - ☒ 4. Cyber law

Question ID : 9489115836

Option 1 ID : 94891123341

Option 2 ID : 94891123343

Option 3 ID : 94891123344

Option 4 ID : 94891123342

Status : Answered

Chosen Option : 2

Q.71 Who among the following is appointed as the deputy Governor of the Reserve Bank of India in October 2020?

- Ans
- ☐ 1. Hasmukh Adhia
 - ☒ 2. Rajeshwar Rao
 - ☐ 3. Ashok Lavasa
 - ☐ 4. Subhash Chandra Garg

Question ID : 9489115807

Option 1 ID : 94891123225

Option 2 ID : 94891123227

Option 3 ID : 94891123228

Option 4 ID : 94891123226

Status : Answered

Chosen Option : 2

Q.72 Find the number of bricks measuring 25 cm in length, 5 cm in breadth and 20 cm in height for a wall 40 m long, 80 cm broad and 6 m in height.

- Ans
- ☐ 1. 75898
 - ☐ 2. 78986
 - ☒ 3. 76800
 - ☐ 4. 74524

Question ID : 9489115367

Option 1 ID : 94891121465

Option 2 ID : 94891121468

Option 3 ID : 94891121466

Option 4 ID : 94891121467

Status : Answered

Chosen Option : 3

Q.73 Eight siblings, L, M, N, O, P, Q, R and S, are sitting around a circular table facing away from the centre and at equal distance from the other, but not in the same order. S sits second to the left of P. M sits third to the right of S. R is M's immediate neighbour and is sitting second to the left of L. N is an immediate neighbour of R. O's back faces the back of N. Q sits to the immediate right of L. Who sits to the immediate right of O?

- Ans**
- ☒ 1. Q
 - ☒ 2. P
 - ☒ 3. S
 - ☒ 4. R

Question ID : 9489115702

Option 1 ID : 94891122805

Option 2 ID : 94891122806

Option 3 ID : 94891122808

Option 4 ID : 94891122807

Status : Answered

Chosen Option : 1

Q.74 If 330 pencils were distributed among Rajesh, Suresh and Chandan in the ratio of $\frac{1}{4} : \frac{2}{3} : \frac{1}{3}$ respectively then how many pencils did Chandan get?

- Ans**
- ☒ 1. 78
 - ☒ 2. 88
 - ☒ 3. 56
 - ☒ 4. 48

Question ID : 9489115360

Option 1 ID : 94891121437

Option 2 ID : 94891121440

Option 3 ID : 94891121438

Option 4 ID : 94891121439

Status : Answered

Chosen Option : 2

Q.75

Which of the following rational number lies between $\frac{1}{4}$ and $\frac{1}{2}$.

Ans

✗ 1. $\frac{1}{8}$

✗ 2. $\frac{3}{5}$

✓ 3. $\frac{3}{8}$

✗ 4. $\frac{1}{6}$

Question ID : 9489115344

Option 1 ID : 94891121375

Option 2 ID : 94891121376

Option 3 ID : 94891121374

Option 4 ID : 94891121373

Status : Answered

Chosen Option : 3

Q.76

A sample of milk from a vessel contains 4% water. What quantity of pure milk should be added to 8 L of milk in the vessel to reduce the water content to 2%?

Ans

✓ 1. 8 L

✗ 2. 7 L

✗ 3. 7.5 L

✗ 4. 6.5 L

Question ID : 9489115356

Option 1 ID : 94891121424

Option 2 ID : 94891121422

Option 3 ID : 94891121423

Option 4 ID : 94891121421

Status : Not Answered

Chosen Option : --

Q.77

P can run 250 m in 25 s and Q can run the same distance in 30 s. By what distance is P ahead of Q after 4.5 s, if both start the race at the same time?

Ans

✗ 1. 6.9 m

✗ 2. 8.4 m

✗ 3. 9.6 m

✓ 4. 7.5 m

Question ID : 9489115363

Option 1 ID : 94891121452

Option 2 ID : 94891121449

Option 3 ID : 94891121450

Option 4 ID : 94891121451

Status : Not Answered

Chosen Option : --

Q.78 In July 2016, the Capitol complex of which Union Territory was declared as the UNESCO World Heritage site under the inscription of 'Architectural work of Le Corbusier'?

- Ans**
- ☒ 1. Chandigarh
 - ☐ 2. Delhi
 - ☐ 3. Diu and Daman
 - ☐ 4. Pondicherry

Question ID : 9489115810

Option 1 ID : 94891123237

Option 2 ID : 94891123238

Option 3 ID : 94891123240

Option 4 ID : 94891123239

Status : Answered

Chosen Option : 1

Q.79 Whose 'State of the Global Climate' report has revealed record sea level rise and exceptionally high land and ocean temperature over the past four years?

- Ans**
- ☐ 1. World Intellectual Property Organisation
 - ☐ 2. United Nation Environment Programme
 - ☒ 3. World Meteorological Organisation
 - ☐ 4. Food and Agriculture Organisation

Question ID : 9489115825

Option 1 ID : 94891123297

Option 2 ID : 94891123299

Option 3 ID : 94891123298

Option 4 ID : 94891123300

Status : Answered

Chosen Option : 3

Q.80 Select the word that does NOT belong to the following group.

Blue, Green, Pink, Yellow

- Ans**
- ☐ 1. Yellow
 - ☐ 2. Green
 - ☐ 3. Blue
 - ☒ 4. Pink

Question ID : 9489115695

Option 1 ID : 94891122780

Option 2 ID : 94891122778

Option 3 ID : 94891122777

Option 4 ID : 94891122779

Status : Answered

Chosen Option : 4

Q.81 UNESCO has named _____ as the World Capital of Architecture for 2020.

- Ans
- ☐ 1. Sao Paulo
 - ☒ 2. Rio de Janeiro
 - ☐ 3. Salvador
 - ☐ 4. Fortalezas

Question ID : 9489115835
Option 1 ID : 94891123338
Option 2 ID : 94891123337
Option 3 ID : 94891123339
Option 4 ID : 94891123340
Status : Answered
Chosen Option : 2

Q.82 Find the number of triangles in the given figure.

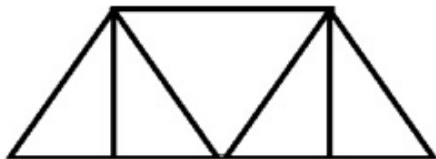

- Ans
- ☐ 1. 5
 - ☒ 2. 7
 - ☐ 3. 8
 - ☐ 4. 3

Question ID : 9489115696
Option 1 ID : 94891122782
Option 2 ID : 94891122783
Option 3 ID : 94891122784
Option 4 ID : 94891122781
Status : Answered
Chosen Option : 2

Q.83 Which of the following cities of Tamil Nadu got a Geographical Identification Tag for Turmeric cultivation in 2019?

- Ans
- ☐ 1. Salem
 - ☒ 2. Erode
 - ☐ 3. Madurai
 - ☐ 4. Coimbatore

Question ID : 9489115823
Option 1 ID : 94891123292
Option 2 ID : 94891123291
Option 3 ID : 94891123289
Option 4 ID : 94891123290
Status : Answered
Chosen Option : 2

Q.84 The sum of the numerator and denominator of a fraction is 11. If the numerator is decreased by 1, the fraction becomes

$\frac{1}{4}$. Find the fraction.

Ans

✓ 1. $\frac{3}{8}$

✗ 2. $\frac{2}{9}$

✗ 3. $\frac{4}{7}$

✗ 4. $\frac{5}{6}$

Question ID : 9489115350

Option 1 ID : 94891121398

Option 2 ID : 94891121397

Option 3 ID : 94891121399

Option 4 ID : 94891121400

Status : Answered

Chosen Option : 1

Q.85 In a code language, BLACK is written as YMZDJ. Which word will be coded as PNZSS in that language?

Ans

✓ 1. SMART

✗ 2. SOUTH

✗ 3. WORTH

✗ 4. WHITE

Question ID : 9489115679

Option 1 ID : 94891122715

Option 2 ID : 94891122713

Option 3 ID : 94891122714

Option 4 ID : 94891122716

Status : Answered

Chosen Option : 1

Q.86 Select the option that is related to the third term in the same way as the second term is related to the first term.

WORLD : 231518124 :: CLOUD : ?

Ans

✗ 1. 31215210

✓ 2. 31215214

✗ 3. 3121515

✗ 4. 31215211

Question ID : 9489115689

Option 1 ID : 94891122755

Option 2 ID : 94891122754

Option 3 ID : 94891122756

Option 4 ID : 94891122753

Status : Answered

Chosen Option : 2

Q.87 The following table shows the expenditure of a factory (in thousands) per annum over the given years.

Year	Raw material	Interest on loan	Sales
2014	88	13.4	321
2015	102	23.5	231
2016	91	31.6	119
2017	123	26.4	201
2018	132	39.4	108

What is the average amount of interest (in thousands) per year that the factory had to pay during the given period?

- Ans**
- ☒ 1. 33.58
 - ☒ 2. 58.68
 - ☒ 3. 26.86
 - ☒ 4. 43.1

Question ID : 9489115690

Option 1 ID : 94891122758

Option 2 ID : 94891122760

Option 3 ID : 94891122759

Option 4 ID : 94891122757

Status : Answered

Chosen Option : 3

Q.88 If GARLIC is coded as 112 then CLOCK will be coded as:

- Ans**
- ☒ 1. 111
 - ☒ 2. 101
 - ☒ 3. 81
 - ☒ 4. 91

Question ID : 9489115691

Option 1 ID : 94891122764

Option 2 ID : 94891122762

Option 3 ID : 94891122761

Option 4 ID : 94891122763

Status : Answered

Chosen Option : 4

Q.89 The distribution of the population of Delhi into seven districts in 2017 is shown in the following pie chart.

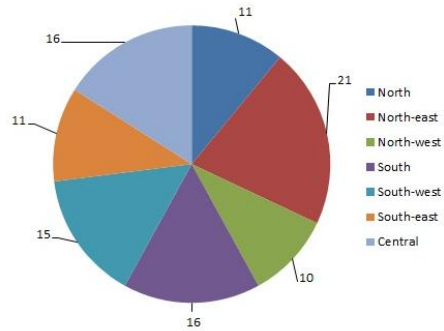

The percentage of the population of each district below poverty line is shown in the following table.

District	Percentage of population below poverty line
North	28
North-east	42
North-west	32
South	41
South-west	39
South-east	36
Central	48

If the population of the north-west district in 2017 is 52000, then what population of the north-east district is below poverty line in that year?

- Ans** ☒ 1. 45864
☒ 2. 45486
☒ 3. 45846
☒ 4. 45684

Question ID : 9489115692

Option 1 ID : 94891122768

Option 2 ID : 94891122766

Option 3 ID : 94891122765

Option 4 ID : 94891122767

Status : Answered

Chosen Option : 1

Q.90 Select the word that does NOT belong to the following group.

Aluminium, Copper, Chlorine, Zinc

- Ans** ☒ 1. Chlorine
☒ 2. Zinc
☒ 3. Aluminium
☒ 4. Copper

Question ID : 9489115694

Option 1 ID : 94891122775

Option 2 ID : 94891122774

Option 3 ID : 94891122773

Option 4 ID : 94891122776

Status : Answered

Chosen Option : 1

Q.91 Select the number that can replace the question mark (?) in the following series.

110, 91, 74, 59, 46, ?

Ans ☒ 1. 35

☒ 2. 33

☒ 3. 27

☒ 4. 29

Question ID : 9489115686

Option 1 ID : 94891122742

Option 2 ID : 94891122743

Option 3 ID : 94891122741

Option 4 ID : 94891122744

Status : Answered

Chosen Option : 1

Q.92 Read the given two statements and decide which of the conclusions given in the options follows from the statements.

Statements:

1: All men are mortal.

2: Philip is a man.

Ans ☒ 1. Philip is not a man.

☒ 2. Philip must be mortal.

☒ 3. All mortal are men.

☒ 4. Philip is not mortal.

Question ID : 9489115676

Option 1 ID : 94891122702

Option 2 ID : 94891122704

Option 3 ID : 94891122703

Option 4 ID : 94891122701

Status : Answered

Chosen Option : 2

Q.93 In a certain code, SYLLABUS is written as SLYALUBS. How will BACKYARD be written as in that code?

Ans ☒ 1. BCYARAKD

☒ 2. ABKCAYDR

☒ 3. ABCKYADR

☒ 4. BCAYKRAD

Question ID : 9489115674

Option 1 ID : 94891122693

Option 2 ID : 94891122695

Option 3 ID : 94891122696

Option 4 ID : 94891122694

Status : Answered

Chosen Option : 4

Q.94 A series is given with one term missing. Select the correct alternative from the given ones that will complete the series.
XPC, QHT, JZK, CRB, ?

- Ans**
- ☒ 1. WKT
 - ☒ 2. XLU
 - ☒ 3. YMV
 - ☒ 4. VJS

Question ID : 9489115683

Option 1 ID : 94891122729

Option 2 ID : 94891122730

Option 3 ID : 94891122731

Option 4 ID : 94891122732

Status : Answered

Chosen Option : 1

Q.95 Select the combination of letters that when sequentially placed in the blanks will create a repetitive pattern.

_baa_aa_aab_

- Ans**
- ☒ 1. abba
 - ☒ 2. aabb
 - ☒ 3. abab
 - ☒ 4. bbaa

Question ID : 9489115687

Option 1 ID : 94891122747

Option 2 ID : 94891122746

Option 3 ID : 94891122745

Option 4 ID : 94891122748

Status : Answered

Chosen Option : 1

Q.96 Select the option in which the words share the same relationship as that shared by the given pair of words.

Freezer : Chill

- Ans**
- ☒ 1. Fridge : Gas
 - ☒ 2. Steam : Boil
 - ☒ 3. Snow : Ice
 - ☒ 4. Geyser : Heat

Question ID : 9489115675

Option 1 ID : 94891122700

Option 2 ID : 94891122698

Option 3 ID : 94891122697

Option 4 ID : 94891122699

Status : Answered

Chosen Option : 4

Q.97 Consider the given statements and decide which of the given assumptions is/are implicit in the statement.

Statement:

"Drop the mail in the mailbox", said John to his assistant.

Assumptions:

1: The assistant knows the address where the mail needs to be sent.

2: The assistant will follow orders.

- Ans** ☒ 1. Only assumption 2 is implicit.
☒ 2. Only assumption 1 is implicit.
☒ 3. None of the assumptions is implicit.
☒ 4. Both assumptions 1 and 2 are implicit.

Question ID : 9489115682

Option 1 ID : 94891122726

Option 2 ID : 94891122725

Option 3 ID : 94891122728

Option 4 ID : 94891122727

Status : Answered

Chosen Option : 4

Q.98 Select the number that can replace the question mark (?) in the following series.

12, 8, 4, 0, -4, ?

- Ans** ☒ 1. 16
☒ 2. -12
☒ 3. 8
☒ 4. -8

Question ID : 9489115684

Option 1 ID : 94891122736

Option 2 ID : 94891122735

Option 3 ID : 94891122734

Option 4 ID : 94891122733

Status : Answered

Chosen Option : 4

Q.99 Select the combination of letters that when sequentially placed in the blanks will create a repetitive pattern.

_stu_vuts_rst_vvu_sr

- Ans**
- ☒ 1. rrvrut
 - ☐ 2. turvr
 - ☐ 3. tsuvr
 - ☐ 4. rvust

Question ID : 9489115688

Option 1 ID : 94891122752

Option 2 ID : 94891122751

Option 3 ID : 94891122749

Option 4 ID : 94891122750

Status : Answered

Chosen Option : 4

Q.100 A, B, C, D and E are sitting on a bench. A and B are sitting next to each other and so are C and D. D is sitting at the extreme left end of the bench and A is sitting at the centre. E is sitting next to B. In which position is A sitting?

- Ans**
- ☐ 1. Between C and E
 - ☐ 2. Between B and D
 - ☐ 3. Between B and E
 - ☒ 4. Between B and C

Question ID : 9489115701

Option 1 ID : 94891122804

Option 2 ID : 94891122801

Option 3 ID : 94891122802

Option 4 ID : 94891122803

Status : Answered

Chosen Option : 4